



General Data

Type Reference:	BF...K
Description:	Contact Block
Approvals:	CCC, cCSAus, ENEC10, VDE, CE, NV, UR
Protection class:	II (protective insulation)
Operation travel:	3 mm
Connection type:	screw connection
Contact material:	AgNi
Max. storage temperature:	-50°C ... 85°C
Max. operating temperature:	-30°C ... 70°C, without illumination -30°C ... 55°C, using incandescent lamps -30°C ... 65°C, using LED's
Mechanical life:	1 m switching cycles
Electrical life (rated load):	1 m operations at rated load
Contact resistance NO:	< 20 mOhm (new state)
Contact resistance NC:	< 20 mOhm (new state)
Min. current:	1 mA
Min. voltage:	5 V
Bouncing time NO:	< 10ms
Bouncing time NC:	< 10ms

Electrical data acc. to IEC/EN 60947-5-1 (VDE 0660 Sect. 200)

Utilisation category:	alternate current AC15 B300	direct current DC13 Q300
Rated insulation voltage U_i :	250 V	300 V
Rated operating voltage U_e :	250 V	250V / 125V / 60V / 24V
Rated operating current I_e :	1.5A	0.2A / 0.4A / 1A / 2A
Breaking capacity:	10Ie	1,1Ie
Continuous thermal current:	6 A	

Electrical data acc. to IEC/EN 61058-1 (VDE 0630 Sect. 1)

Rated voltage U_e :	250 V~
Rated current I_e :	6(4) A

Technical Data - Lamp

Lamp socket:	T5,5K / W2x4,6d
Max. lamp voltage:	60V
Max. lamp output:	1.2W
Definition:	X1...anode, X2...cathode

Electrical Features

Operational voltage:	20mV ... 42V AC/DC
Switching current:	1mA ... 250mA
Contact resistance (new state):	< 50 mOhm
Tightening torque (screw terminal):	0.4 Nm

Additional Electrical Data

Overvoltage category:	II
-----------------------	----

Mounting Instructions

1.

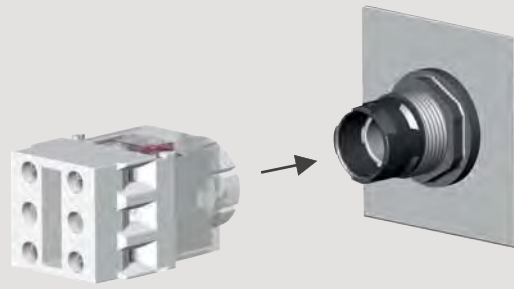

2.

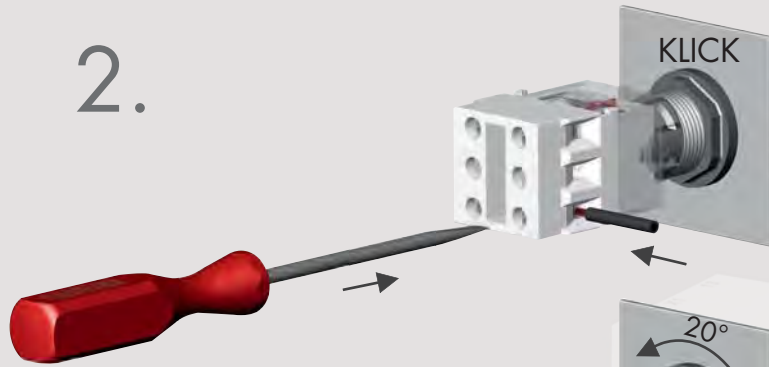

3.

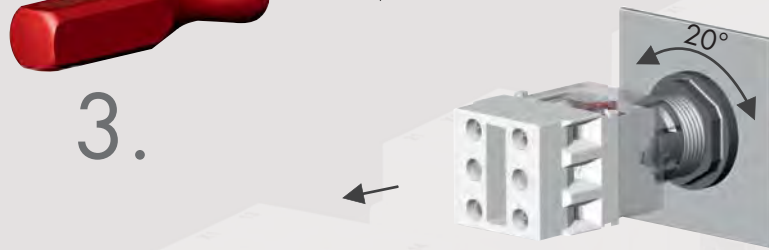

About Us

Control Units

→ Contact Blocks

Panel Mount Jacks

Bus Technology

Enclosures

Terminal Blocks

Pedal Switches

Limit Switches

Type Index

Illustration	Description	Type
 <p>3 mm</p> <p>0 1 2 3</p> <p>22/21</p> <p>14/13</p> 	<p>Contact Block, maintained 1NC + 1NO screw connection 2.5 mm²</p> <p>suitable actuators</p>  <p>contact material AgNi</p>	BFK
 <p>3 mm</p> <p>0 1 2 3</p> <p>22/21</p> <p>14/13</p> 	<p>Illuminated Contact Block, maintained 1NC + 1NO screw connection 2.5 mm² lamp socket W2x4,6d</p> <p>suitable actuators</p>  <p>contact material AgNi</p>	BFLK
 <p>3 mm</p> <p>0 1 2 3</p> <p>22/21</p> <p>14/13</p> 	<p>Illuminated Contact Block, maintained 1NC + 1NO screw connection 2.5 mm² lamp socket T5,5K</p> <p>suitable actuators</p>  <p>contact material AgNi</p>	BFL5K
 <p>3 mm</p> <p>0 1 2 3</p> <p>24/23</p> <p>14/13</p> 	<p>Contact Block, maintained 2NO screw connection 2.5 mm²</p> <p>suitable actuators</p>  <p>contact material AgNi</p>	BFIK
 <p>3 mm</p> <p>0 1 2 3</p> <p>24/23</p> <p>14/13</p> 	<p>Illuminated Contact Block, maintained 2NO screw connection 2.5 mm² lamp socket W2x4,6d</p> <p>suitable actuators</p>  <p>contact material AgNi</p>	BFLIK
 <p>3 mm</p> <p>0 1 2 3</p> <p>24/23</p> <p>14/13</p> 	<p>Illuminated Contact Block, maintained 2NO screw connection 2.5 mm² lamp socket T5,5K</p> <p>suitable actuators</p>  <p>contact material AgNi</p>	BFL5K
 <p>3 mm</p> 	<p>Lampholder screw connection 2.5 mm² lamp socket W2x4,6d</p> <p>suitable pilot light heads</p> 	BL4K
 <p>3 mm</p> 	<p>Lampholder screw connection 2.5 mm² T5,5K socket lamp socket T5,5K</p> <p>suitable pilot light heads</p> 	BL5K

About Us

Control Units
→ Contact Blocks

Panel Mount Jacks

Bus Technology

Enclosures

Terminal Blocks

Pedal Switches

Limit Switches

Type Index

Contact Blocks

screw connection 2.5 mm²

made in germany

SCHLEGEL
ELEKTROKONTAKT

About Us

Contact Units

Panel Mount Jacks

Bus Technology

Enclosures

Terminal Blocks

Pedal Switches

Limit Switches

Type Index

Illustration

Description

Type



Ultra-bright LED, W2x4,6d socket, 12V

with half-wave rectifier, for 12 V AC/DC (6/12 mA)

When connecting to DC, the correct polarity must be observed:

+ ... X1/- ... X2

storage temperature:

-25°C ... +80°C

ambient temperature:

-20°C ... +60°C

voltage tolerance:

+ 10 %

colour

white

L2X4,6-12UW



Ultra-bright LED, W2x4,6d socket, 24V

with half-wave rectifier, for 24 V AC/DC (2/4 mA)

When connecting to DC, the correct polarity must be observed:

+ ... X1/- ... X2

storage temperature:

-25°C ... +80°C

ambient temperature:

-20°C ... +60°C

voltage tolerance:

+ 10 %

colour

white

L2X4,6-24UW

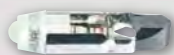

Ultra-bright LED, T5,5K socket, 12V

with integrated series resistor and half-wave rectifier, for 12 V AC/DC (7/14 mA)

When connecting to DC, the correct polarity must be observed:

+ ... X1/- ... X2

storage temperature:

-25°C ... +80°C

ambient temperature:

-20°C ... +60°C

voltage tolerance:

+ 10 %

colour

white

L5,5K12UW



Ultra-bright LED, T5,5K socket, 24V

with integrated series resistor and half-wave rectifier, for 24 V AC/DC (7/14 mA)

When connecting to DC, the correct polarity must be observed:

+ ... X1/- ... X2

storage temperature:

-25°C ... +80°C

ambient temperature:

-20°C ... +60°C

voltage tolerance:

+ 10 %

colour

white

L5,5K24UW

Illustration	Description	Type
--------------	-------------	------



Two-colour LED, T5,5K socket - 24V

with integrated series resistor
colour dependent on polarity
Storage temperature:
-25°C ... +80°C
Ambient temperature:
-20°C ... +60°C
Voltage tolerance: + 10 %

Colour:	red	
green		
Rated current [mA]:	14	13
Brightness [mcd]:	2300	650
Dominant wavelength: [nm]	625	525

colour red/green **L5,5K24RG**



Ultra-bright LED

solder pins, grid 2.54 mm
ready-made for CTP_485

3680 mcd white

LED3UW

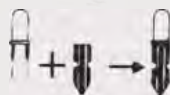

LED Adapter

for LEDs of 3 and 5 mm Ø to be used in
T5.5K sockets,
an external resistor must be provided.

lamp socket T5,5K

LA5,5



Voltage Reducer (for LEDs)

Faston terminals 2.8x0.8 mm
to operate a LED at 230V AC

VE_LED230



Cable Set with wire end ferrules

suitable for VE_LED230

VE_VKAE

About Us

Control Units
→ Contact Blocks

Panel Mount Jacks

Bus Technology

Enclosures

Terminal Blocks

Pedal Switches

Limit Switches

Type Index