

6

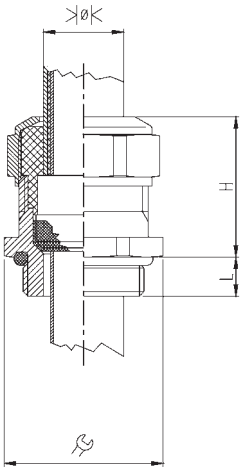

## EMV-Kabelverschraubungen Messing mit Kontakthülse

**Progress - EMV/EX**

Material: Messing vernickelt  
 Dichtung: TPE  
 Einsatztemp.: Von -20°/+100°C  
 Schutzart: IP 68  
 Ausführung: EEx e II  
 Prüfnorm: EN50014 / EN 50019  
 EG Baumusterprüfbescheinigung  
 PTB 02 ATEX 1126 X

## EMC cable glands nickel-plated brass with contact socket

**Progress - EMV/EX**

Material: Nickel-plated brass  
 Seal: TPE  
 Temp. range: -20°/+100°C  
 Protection class: IP 68  
 Version: EEx e II  
 Test standard: EN 50014 / EN 50019  
 EC-type examination certificate  
 PTP 02 ATEX 1126 X



ATEX 95



HUGRO No	AGRO No	M	mm	mm	H mm	L mm	
----------	---------	---	----	----	------	------	--

**Kurzer, einteiliger Dichtungseinsatz**  
**Kurzes Anschlussgewinde metrisch**  
**(nicht durchgehend isoliert)**

**Short, one-piece sealing insert**  
**Short entry thread metric**  
**(not overall length insulated)**

<b>107.0803.10</b>	EX1080.08.035	M 8x1,25	2,5- 3,5	11	14	5,0	50
<b>107.0804.10</b>	EX1080.08.040	M 8x1,25	3,0- 4,0	11	14	5,0	50
<b>107.1004.10</b>	EX1080.10.040	M10x1,50	3,0- 4,0	13	15	5,0	50
<b>107.1006.10</b>	EX1080.10.060	M10x1,50	4,0- 6,0	13	15	5,0	50
<b>107.1506.10</b>	EX1080.12.060	M12x1,50	4,5- 6,0	15	17	5,0	50
<b>107.1507.10</b>	EX1080.12.075	M12x1,50	6,0- 7,5	15	17	5,0	50
<b>107.1708.10</b>	EX1080.17.080	M16x1,50	6,0- 8,0	18	20	5,0	50
<b>107.1710.10</b>	EX1080.17.100	M16x1,50	8,0-10,0	18	20	5,0	50
<b>107.2011.10</b>	EX1080.20.110	M20x1,50	8,0-11,0	24	21	6,0	50
<b>107.2014.10</b>	EX1080.20.140	M20x1,50	12,5-14,0	24	21	6,0	50
<b>107.2516.10</b>	EX1080.25.160	M25x1,50	11,0-16,0	30	25	7,0	25
<b>107.2519.10</b>	EX1080.25.190	M25x1,50	17,0-19,0	30	25	7,0	25
<b>107.3221.10</b>	EX1080.32.210	M32x1,50	17,0-21,0	36	29	8,0	25
<b>107.4028.10</b>	EX1080.40.285	M40x1,50	23,0-28,5	46	31	8,0	10
<b>107.5037.10</b>	EX1080.50.370	M50x1,50	32,0-37,0	55	34	9,0	10
<b>107.6346.10</b>	EX1080.63.460	M63x1,50	39,0-46,0	70	37	10,0	5

**Kurzer, einteiliger Dichtungseinsatz**  
**Kurzes Anschlussgewinde Pg**  
**(nicht durchgehend isoliert)**

**Short, one-piece sealing insert**  
**Short entry thread Pg**  
**(not overall length insulated)**

<b>107.0706.10</b>	EX1080.07.060	Pg 7	4,5- 6,0	15	17	6,0	50
<b>107.0707.10</b>	EX1080.07.075	Pg 7	6,0- 7,5	15	17	6,0	50
<b>107.0908.10</b>	EX1080.09.080	Pg 9	6,0- 8,0	18	20	6,0	50
<b>107.0910.10</b>	EX1080.09.100	Pg 9	8,0-10,0	18	20	6,0	50
<b>107.1108.10</b>	EX1080.11.085	Pg 11	5,5- 8,5	21	21	6,0	50
<b>107.1112.10</b>	EX1080.11.120	Pg 11	8,5-12,0	21	21	6,0	50
<b>107.1311.10</b>	EX1080.13.110	Pg 13	8,0-11,0	24	21	6,0	50
<b>107.1314.10</b>	EX1080.13.140	Pg 13	12,5-14,0	24	21	6,0	50
<b>107.1611.10</b>	EX1080.16.110	Pg 16	8,0-11,0	24	21	6,0	50
<b>107.1614.10</b>	EX1080.16.140	Pg 16	12,5-14,0	24	21	6,0	50
<b>107.2116.10</b>	EX1080.21.160	Pg 21	11,0-16,0	30	25	7,5	25
<b>107.2119.10</b>	EX1080.21.190	Pg 21	17,0-19,0	30	25	7,5	25
<b>107.2923.10</b>	EX1080.29.230	Pg 29	19,0-23,0	38	29	8,0	25
<b>107.2925.10</b>	EX1080.29.255	Pg 29	23,0-25,5	38	29	8,0	25
<b>107.3630.10</b>	EX1080.36.305	Pg 36	25,0-30,5	50	32	8,0	10
<b>107.4237.10</b>	EX1080.42.370	Pg 42	33,0-37,0	55	34	10,0	10
<b>107.4843.10</b>	EX1080.48.430	Pg 48	39,0-43,0	65	37	11,0	10

**Lange Anschlussgewinde metrisch + Pg**  
**auf Anfrage erhältlich!**

**Long entry thread metric + Pg**  
**available upon request!**

Technische Änderungen vorbehalten!

Technical modifications are subject to change!