

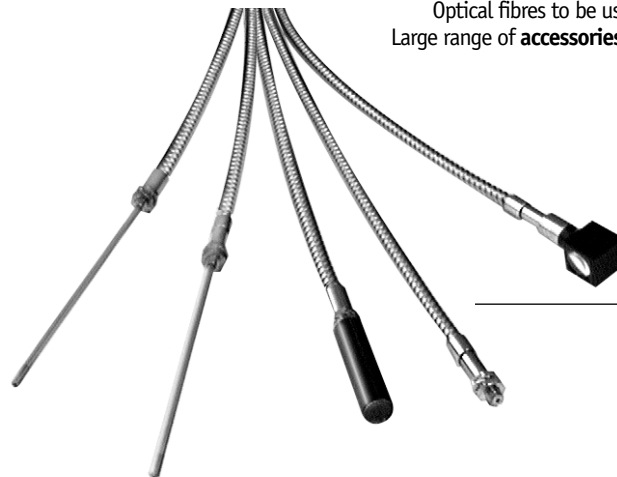

SERIE	CV
Glass optical fibre for high temperatures	
<ul style="list-style-type: none"> ◆ Models with flexible fibre heads (with sleeve) ◆ Wide range of accessories (AF serie) ◆ IP67 protection degree ◆ FS1 and FX2 serie connectable 	

Glass optical fibres heat resistant up to 250°C

Optical fibres to be used at high temperature.
Large range of **accessories (AF serie)** available to
increase distances
or for precise detections



ORDERING SYSTEM								
	model ^{(1) (3)}	type	with FS1	with FX2	∅ fibre (core)	free-cut	fibre length ⁽²⁾	head shape (mm)
High temp.	CV/CB1-**	diffuse reflection	50 mm	80mm	1mm	no	1-2 m	M4
	CV/CB3-**	diffuse reflection	50 mm	80mm	1mm	no	1-2 m	M4 with sleeve
	CV/RB4-**	through-beam	90 mm	250mm	1mm	no	1-2 m	M4 with sleeve
	CV/RB6-**	through-beam	90 mm	250mm	1mm	no	1-2 m	M4

(1) The last two bits of the code show the fiber length (in dm) - (2) Standard length. Special lengths are available on request.
(3) The following characteristic curves refer only to FX2 serie.

MODEL	CV/CB1-**
diffuse reflection (high temperature)	
Optical fibre core ∅	1 mm
Distance (with FS1)	50 mm
Distance (with FX2)	80mm
Fibre length (L)	1 - 2 m
Free-cut	no
Head shape	M4
Protection degree	IEC IP67
Temperature range	-40°....+250°C
Optical fibre materials	glass,ETM,stainless steel
Head materials	nickel-plated brass
Accessories available	AF/FC1, AF/FC2

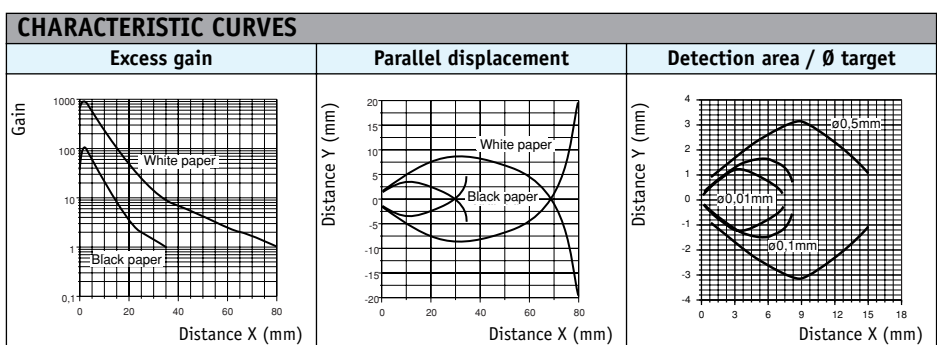
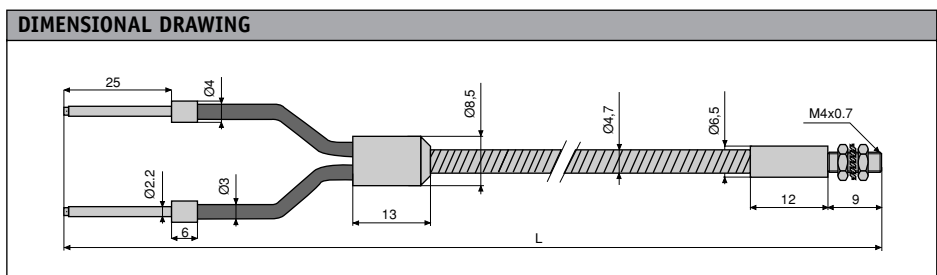

MODEL	CV/CB3-**
diffuse reflection with sleeve (high)	
Optical fibre core Ø	1 mm
Distance (with FS1)	50 mm
Distance (with FX2)	80mm
Fibre length (L)	1 - 2 m
Free-cut	no
Head shape	M4 with sleeve
Protection degree	IEC IP67
Temperature range	-40°....+250°C
Optical fibre materials	glass,ETM,stainless steel
Head materials	nickel-plated brass
Accessories available	none

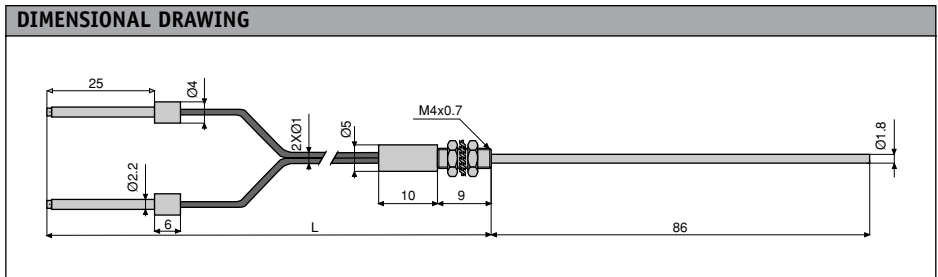

CHARACTERISTIC CURVES		
Excess gain	Parallel displacement	Detection area / Ø target

MODEL	CV/RA4-**
through-beam with sleeve (high temp.)	
Optical fibre core Ø	1 mm
Distance (with FS1)	90 mm
Distance (with FX2)	250mm
Fibre length (L)	1 - 2 m
Free-cut	no
Head shape	M4 with sleeve
Protection degree	IEC IP67
Temperature range	-40°....+250°C
Optical fibre materials	glass,ETM,stainless steel
Head materials	nickel-plated brass
Accessories available	nessuno

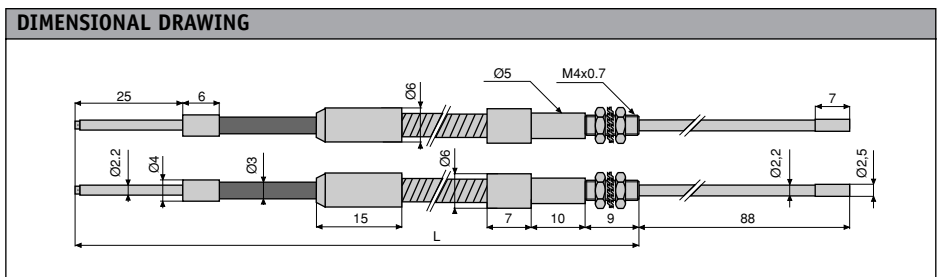

CHARACTERISTIC CURVES		
Excess gain	Parallel displacement	Mutal interference

MODEL	CV/RB6-**
through-beam (high temperature)	
Optical fibre core Ø	1 mm
Distance (with FS1)	90 mm
Distance (with FX2)	250mm
Fibre length (L)	1 - 2 m
Free-cut	no
Head shape	M4
Protection degree	IEC IP67
Temperature range	-40°....+250°C
Optical fibre materials	glass,ETM,stainless steel
Head materials	nickel-plated brass
Accessories available	see AF series

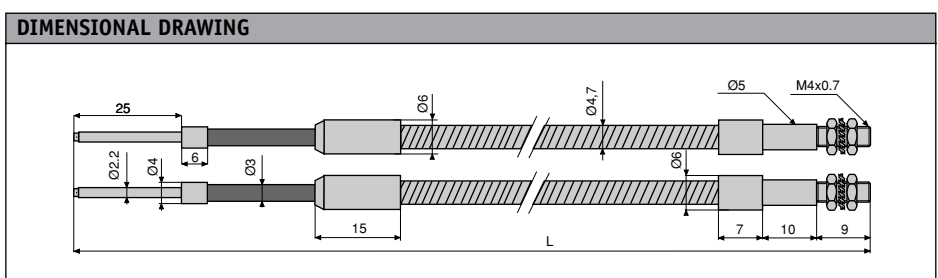

CHARACTERISTIC CURVES		
Excess gain	Parallel displacement	Mutal interference